

kD300 Noise Diodes

100 MHz to 100 GHz



kTB Noise Diodes

kTB'S noise diodes are the fundamental building blocks of all noise systems. They are hand-picked for performance characteristics that make them ideally suited to broadband noise generation with flat response.

All kTB noise diodes deliver symmetrical white Gaussian noise and flat output power versus frequency. The diodes are hermetically sealed and available in a wide variety of package styles. Special package configurations or screening processes are available upon request.

Model	Frequency Range	Operating Voltage (v)	ENR (db)	Impedance (ohm)	Bias (mA)
kD300	100MHz to 100GHz	6-12V	30	50	8mA (typical)

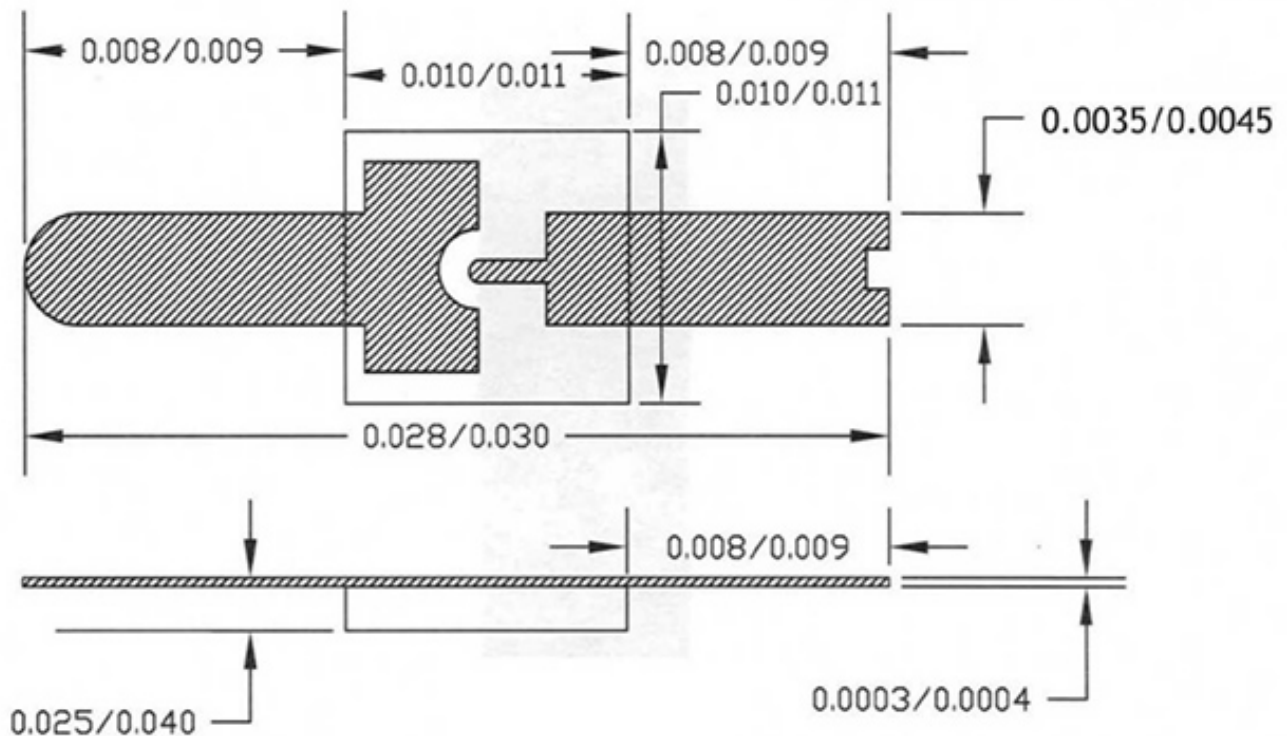

Features

- Custom electrical testing available upon request.
- Wide package variety with custom configurations.
- Can deliver symmetrical white Gaussian noise and flat output power versus frequency.
- Be used for RF and Microwave application
- Classified based on performance traits that improve their broadband noise output and produce a flat spectral response.